

New



- * Bearing Type
Ball Bearings
- * Material
Impeller & Frame : Plastic (UL 94V-0)
- * Lead Wires :
UL 1061 AWG #26 OR Equivalent
Red Wire Positive(+)
Black Wire Negative(-)
- * Weight : 25g (0.88 oz)
- * RIB Type Only

AFB 40 x 40 x 15 MM SERIES

■ DIMENSIONS DRAWING

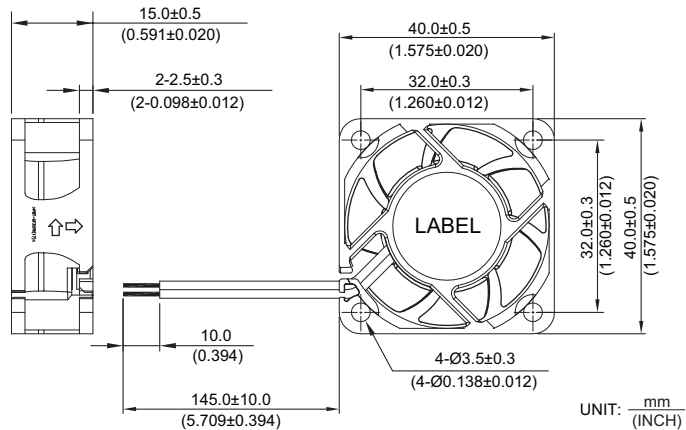

■ P & Q CURVE (AT RATED VOLTAGE)

■ MOUNTING PANEL CUTOUT

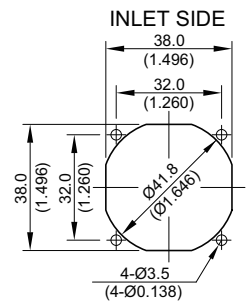
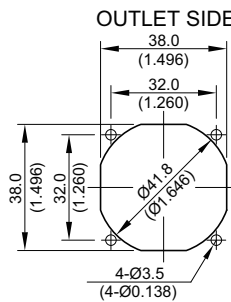
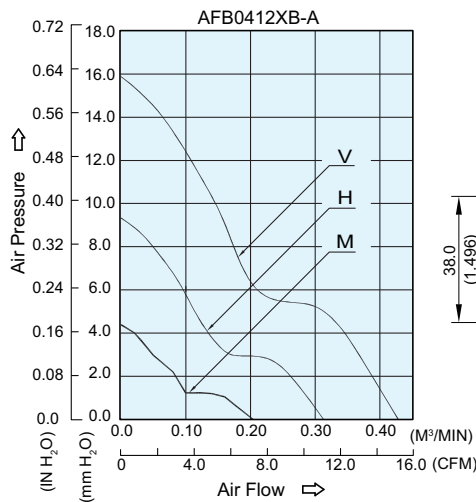

UNIT: mm (INCH)

MODEL			Rated Voltage	Operating Voltage Range	Input Current	Input Power	Speed	Maximum Air Flow		Maximum Air Pressure		Noise
PART NO.	REV.	FUNCTION	VDC	VDC	Amp	Watt	R.P.M.	m ³ /min	CFM	mmH ₂ O	IN H ₂ O	dB-A
AFB0412MB	-A	-R00 / -F00	12	5.0 to 13.2	0.07	0.84	6000	0.210	7.42	4.38	0.172	24.0
AFB0412HB	-A	-R00 / -F00	12	5.0 to 13.2	0.15	1.80	9000	0.320	11.30	9.33	0.367	33.0
AFB0412VB	-A	-R00 / -F00	12	5.0 to 13.2	0.21	2.52	12000	0.430	15.18	15.80	0.622	41.5

- * Function type is optional.
- * The max. air flow and the speed are measured in free air ; max. air pressure is measured at zero air flow.
- * Noise is measured in anechoic chamber in free air, one meter from intake side.
- * All readings are typical values at rated voltage.
- * Specifications are subject to change without notice.